

Sladen Mill, Halifax Road, Littleborough, OL15 0LB

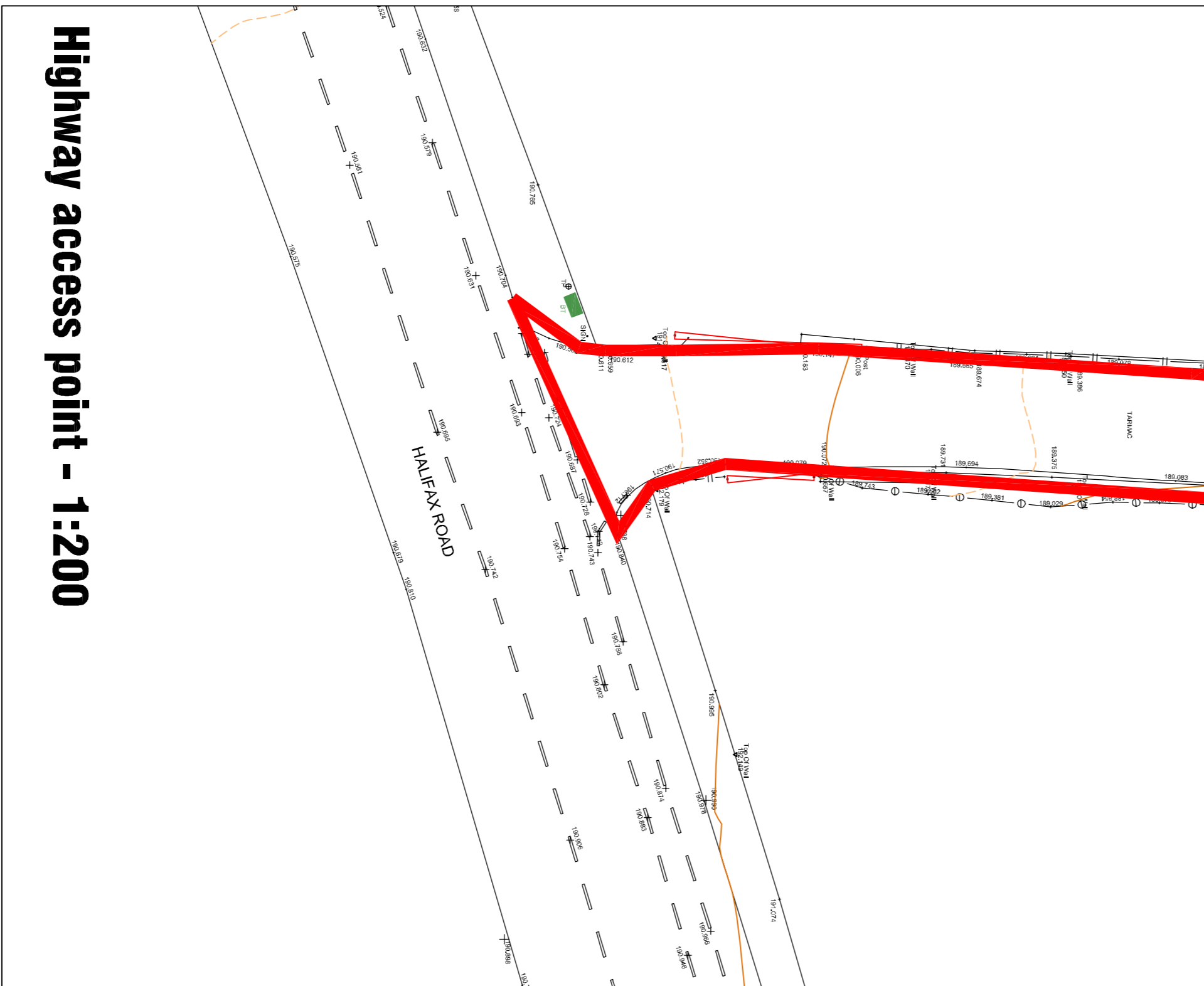
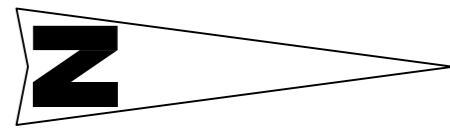

Site layout plan - 1:500

0m 10m 20m 30m 40m 50m

Scale Bar 1:500

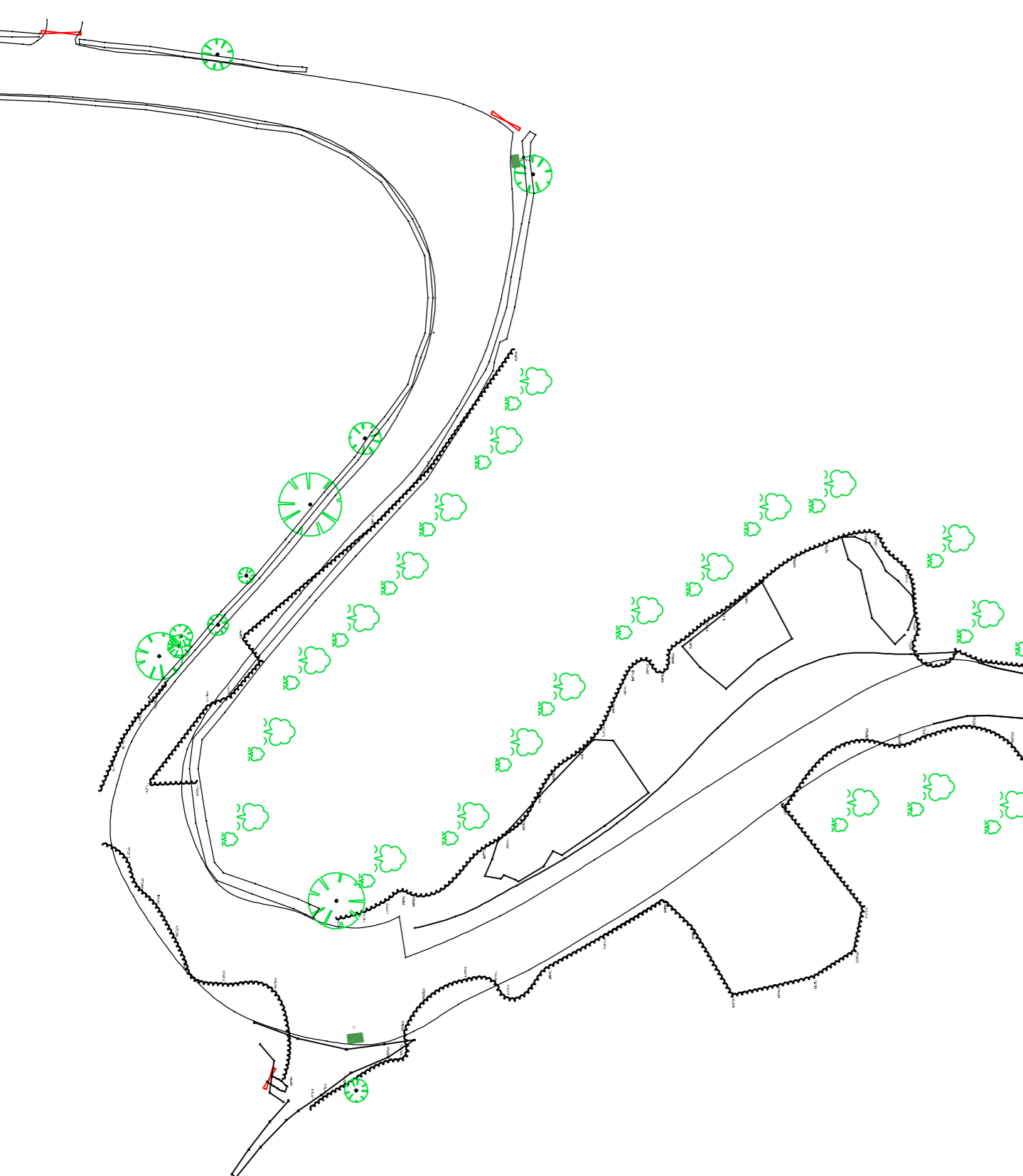

Site location plan - 1:1250



NOTES

Developable site area : 12533m²
3.09 acres/1.256 ha
(edged in red)

Existing building volume = 25750m³+

Existing building footprints shown dashed red

<p>Chartered Institute of Architectural Technicians Registered Practice</p>		<p>bpd Architecture CIAT Registered Practice Suite 11, Health House, 5 East Terrace, Park, Sutton Lane Littleborough, Greater Manchester, M6 1JH Tel: 01257 220510 Fax: 01257 220511 web: www.bpdarch.co.uk email: info@bpdarch.co.uk</p>	
<p>Rev D - Approval configuration and associated car parking added, Nov 2017</p> <p>Rev C - Red Edge plan amended, October 2015</p> <p>Rev B - Layout amended in accordance with feedback from Planning, March 2015</p> <p>Rev A - Layout amended in accordance with initial feedback from Planning, Nov 2014</p>	<p>Project Sladen Mill, Halifax Road, Littleborough, Rochdale OL15 0LB</p> <p>Title Proposed Sketch planning layout Residential</p> <p>Scale @ A1 1:500</p> <p>Date July 2014</p> <p>Ref Job 500</p> <p>Drawn MDB</p> <p>Rev D</p>	<p>500/SML/PL</p>	<p>Drawn MDB</p>