

Contractors must check all dimensions on site. Repairs to be reported immediately to the Supervising Officer before proceeding. IF IN DOUBT, ASK.

- Notes
- FLOOR MOVEMENT JOINT (M40, M070)
 - EXISTING FOUL DRAINAGE
 - NEW FOUL DRAINAGE
 - NEW ABOVE GROUND WASTE PIPEWORK

1. SEE DRAWINGS GMN/51/90/6 at J 7 FOR DETAILS AND SCHEDULE OF DRAINAGE CASTINGS.

**PSA GROUP NORTH
BLOCK E
BROOKLANDS AVENUE
CAMBRIDGE.**

QMP Management & Design

Agency
Tel: (0208) 437882
Fax: (0208) 437883
Cambridge
Tel: (0223) 233173
Fax: (0223) 233174
Kettering
Tel: (0203) 754515
Fax: (0203) 754516
Northampton
Tel: (0204) 300000
Wolverhampton
Tel: (0902) 71280

QMP

Client
Property Services Agency

Project
**R.A.F. COLTISHALL
Refurbish Officers Mess Kitchen
Building N°50**

Drawing Title
**DRAINAGE AND FLOOR
MOVEMENT JOINT DETAILS**

Date
MAY 1990

Drawn
N DALE

Scale
1:50

Revision

Drawing No.
GMN / 51 / 90 / 5

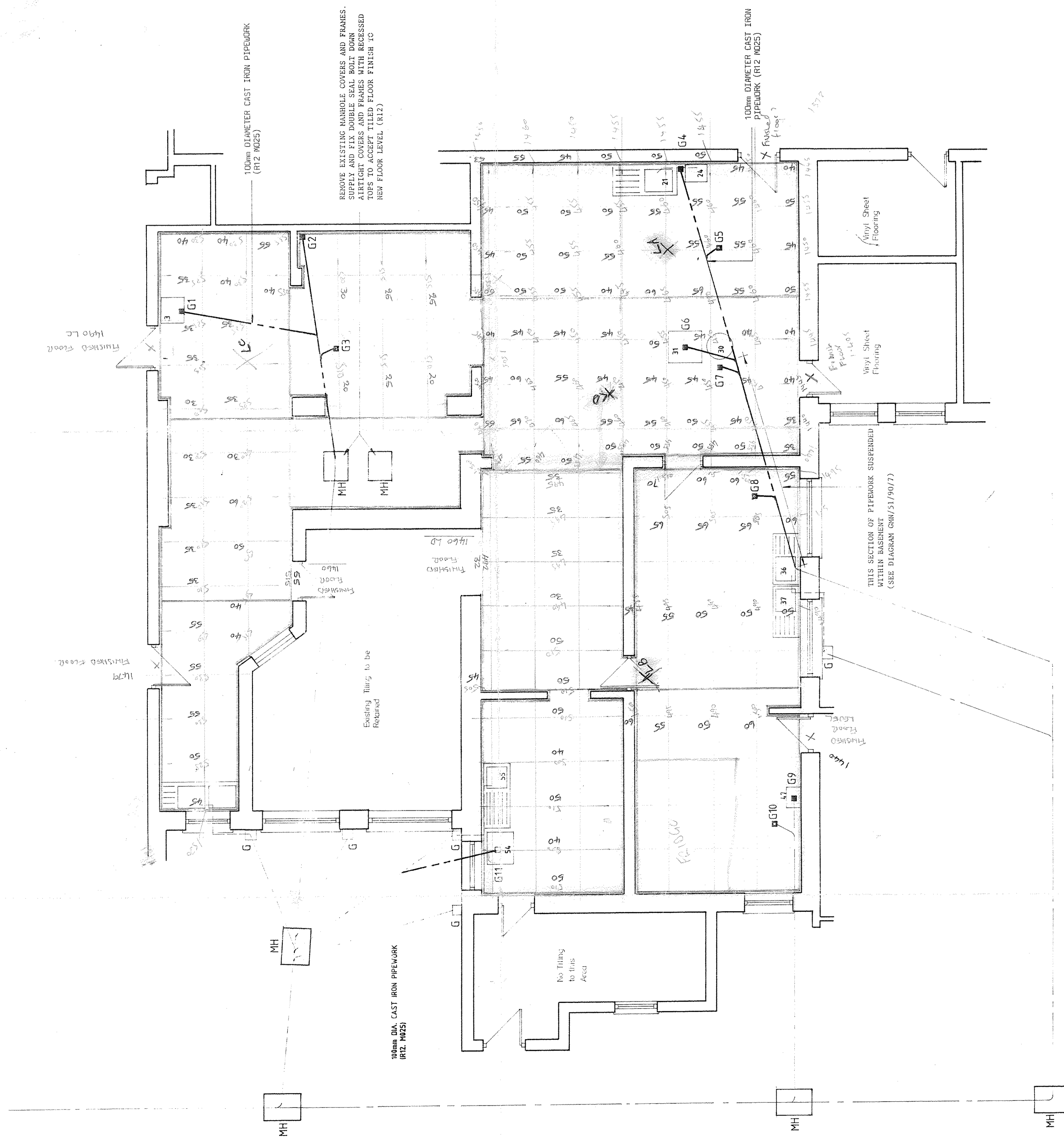

ARCHIVED TO CD

6025