

M.B. 25

H.M. LAND REGISTRY

Filed Plan of Title No. EX79054

Scale 1/2500

County—*ESSEX.*
O.S. Sheet *708289*

Crown Copyright Reserved

518273 872123 W1.61377 D339 4/61 7M T&Co. G837

THE BOUNDARIES SHOWN BY DOTTED LINES HAVE BEEN PLOTTED FROM THE PLANS ON THE DEEDS AND ARE SUBJECT TO REVISION ON SURVEY.

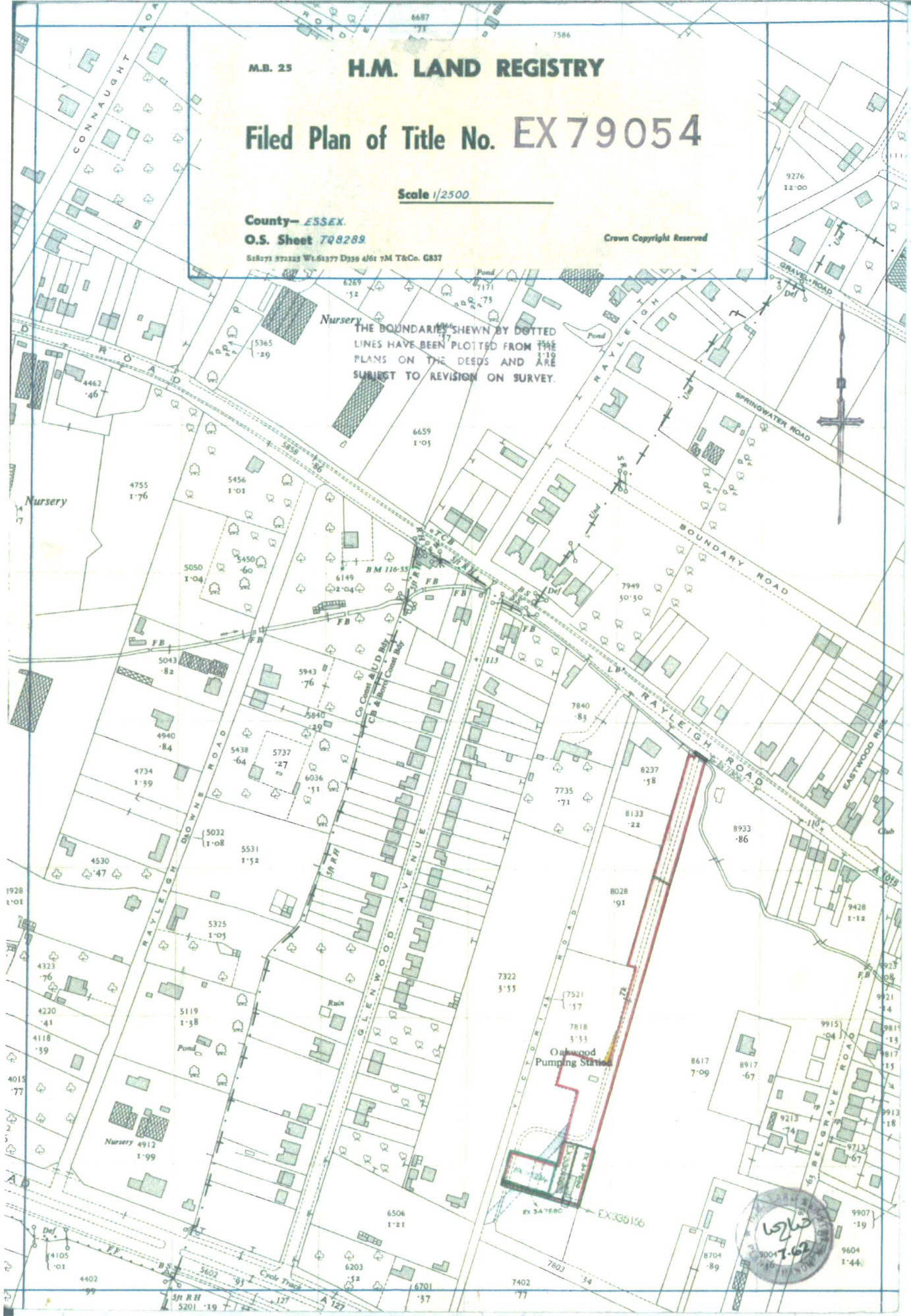

This is a print of the view of the title plan obtained from Land Registry showing the state of the title plan on 05 September 2012 at 14:19:01. This title plan shows the general position, not the exact line, of the boundaries. It may be subject to distortions in scale. Measurements scaled from this plan may not match measurements between the same points on the ground. See Land Registry Public Guide 19 - Title plans and boundaries.

This title is dealt with by Land Registry, Peterborough Office.

©Crown Copyright. Produced by Land Registry. Reproduction in whole or in part is prohibited without the prior written permission of Ordnance Survey. Licence Number 100026316.